

SIVER

That's what you need for efficient work!

Straightening system for frames of heavy commercial trucks

A rail system, embedded in concrete flush with the concrete floor forms the basis of the system.

As pulling devices horizontal pullers and vertical jacks are used. Additionally a high-front support and chains with retainer are provided.



The manufacturer reserves the right to make changes to the product design and configuration without prior notice

WWW.SIVER.SU

Manufacturer: SIVER CJSC
248025, Kaluga, Novoslobodskaya, 27
tel./fax (Kaluga): (4842) 79 18 04
tel. (Moscow): (495) 780 46 84

MADE IN RUSSIA



Vehicle and pulling devices attachment

The vehicle's attachment to the frame is accomplished with two opposite acting forces.

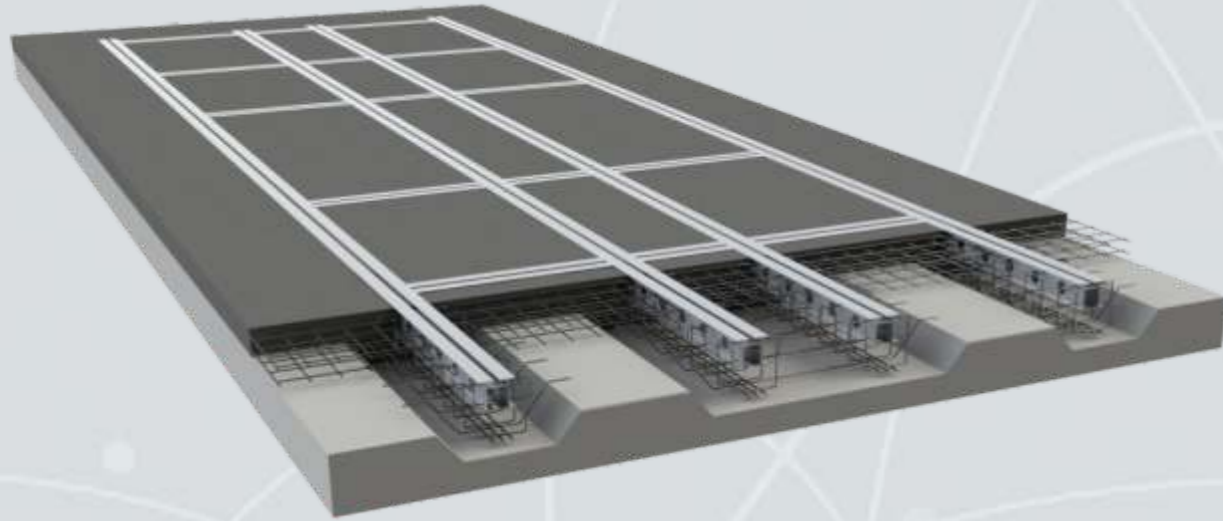

A set of rails – 1 set
Frame dimensions - 4,7 m x 16 m



(you can increase/decrease the length)

Technical documents for «do-it-yourself» manufacturing are available.

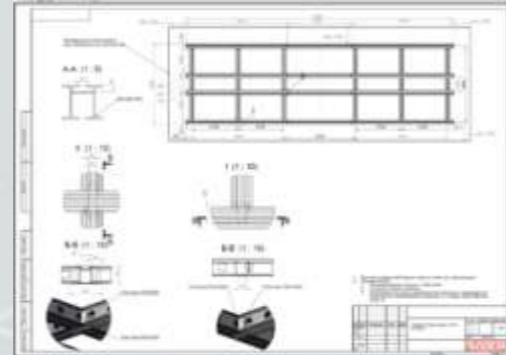

Frame repair in horizontal plane

To repair a frame skewing in horizontal plane a force created by the horizontal puller shall be applied, while reference points shall be installed opposite. To adjust the force application height "force triangles" are provided, installed both on the pulling device and on the supports.

Example of force application



A set of pulling supports with a set of locks



Horizontal puller – 2 pcs.

Handy wheels for motion
Removable handle
Set of anchors
Force of hydraulic cylinder 20 t
Rod stroke – 28 cm
Spacing between pulling devices - 80 mm

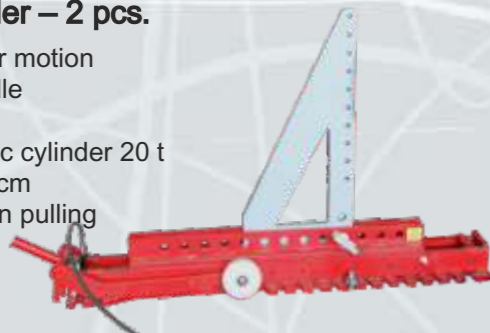

Horizontal support – 1 pcs.

Handy wheels for motion
Removable handle
Set of anchors



Vehicle and pulling devices attachment

To repair a frame skewing in vertical plane the vertical pulling device is used, while the frame is fixed with chains and rollers.

Example of force application



Vertical jack – 2 pcs.



Equipped with spring-loaded wheels for fast and comfortable movement.
Minimum height - 500
Maximum height - 1126
Rod stroke - 300 mm
Height adjustment step - 50 mm
Hydraulic cylinder force - 20 t.

Frame jam repair

Hydraulic clamps



Force 10 t – 1 pc.



Force 20 t – 1 pc. (optional)

Anchor rollers

Are used to attach the vehicle's frame to the rail system, as well as to change the pulling direction.



large – 2 pcs.

small – 2 pcs.

Pneumohydraulic power unit

Control by 4 hydraulic cylinders simultaneously
Force monitoring with a pressure gauge
Operational pressure 7-14 bar
Oil tank volume 7,5 liter

